

How to setup Microsoft Authenticator to your SFC account.



ST FRANCIS
COLLEGE EST. 1859

This guide provides a straightforward process for setting up Microsoft Authenticator with your SFC account, enhancing your account's security through two-factor authentication. By following the steps outlined, you can easily link your mobile device to your account, ensuring safer access and protection against unauthorized logins. It's essential for anyone looking to bolster their online security and streamline their login experience.

- 1 Go to <https://aka.ms/mfasetup> to begin setup and enter your school email

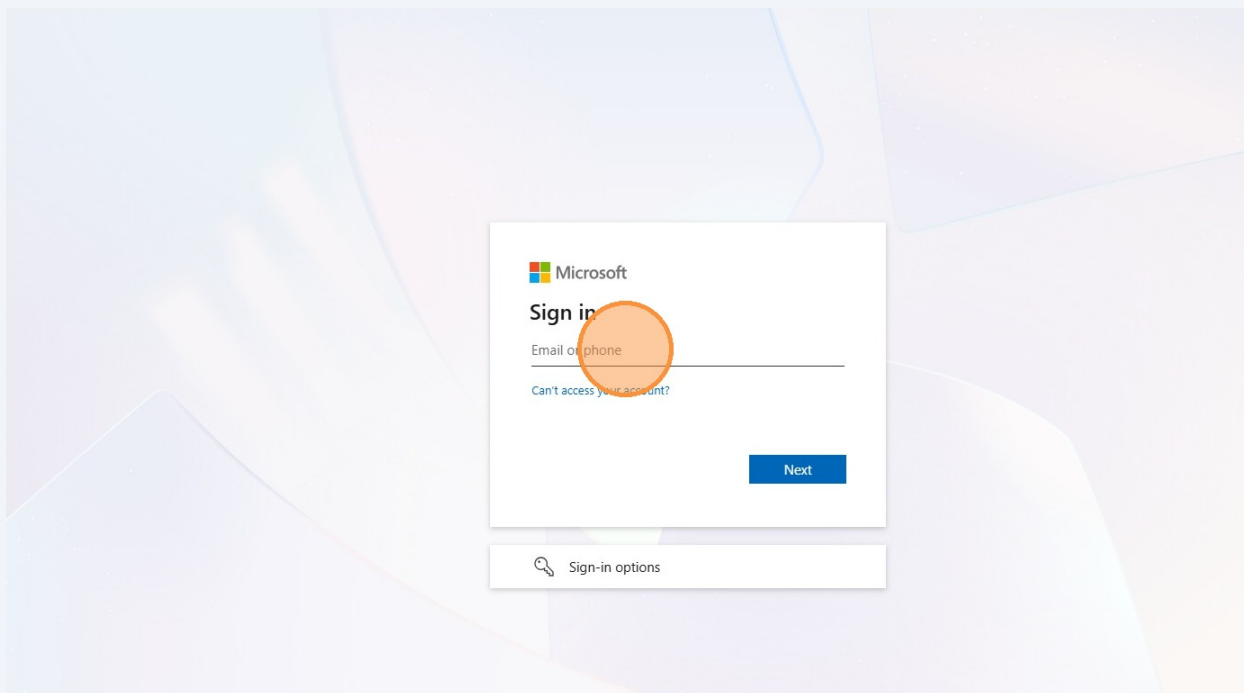

2 Enter Password and then click "Sign in"

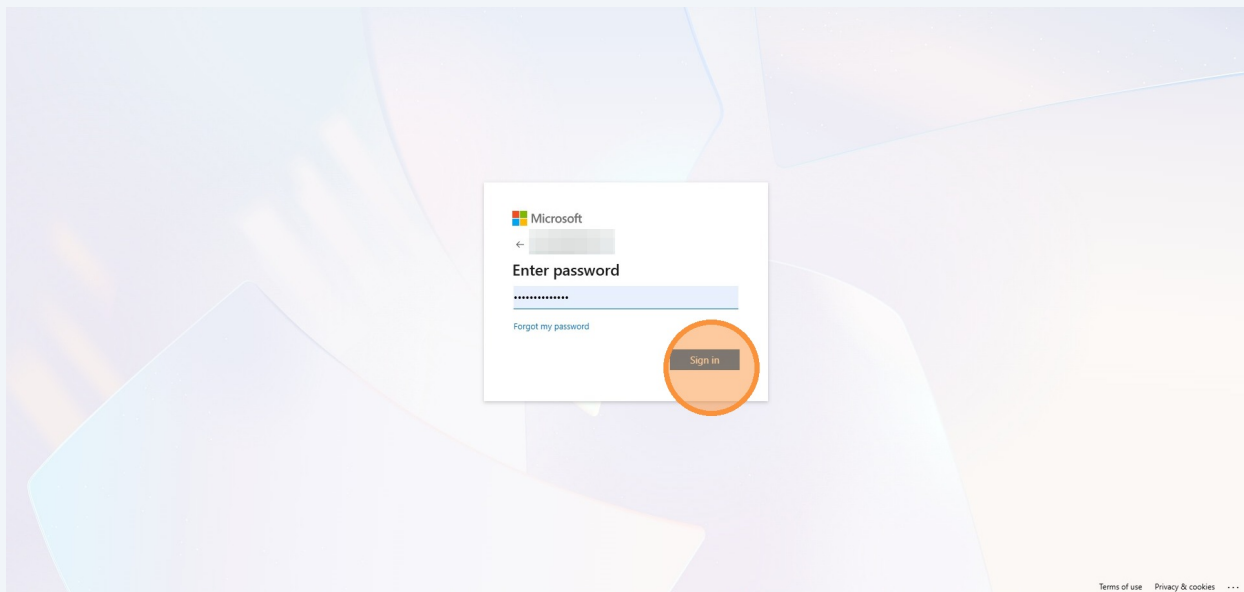

3 Click "Next"

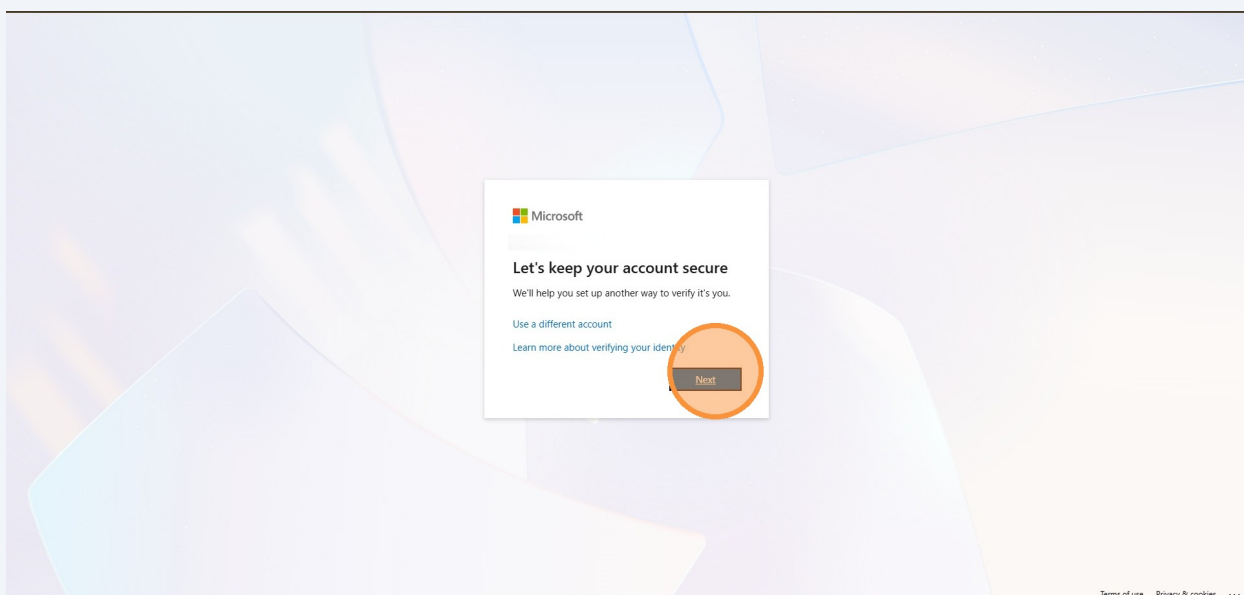

4

Download the MICROSOFT Authenticator to your mobile device and then click "Next"

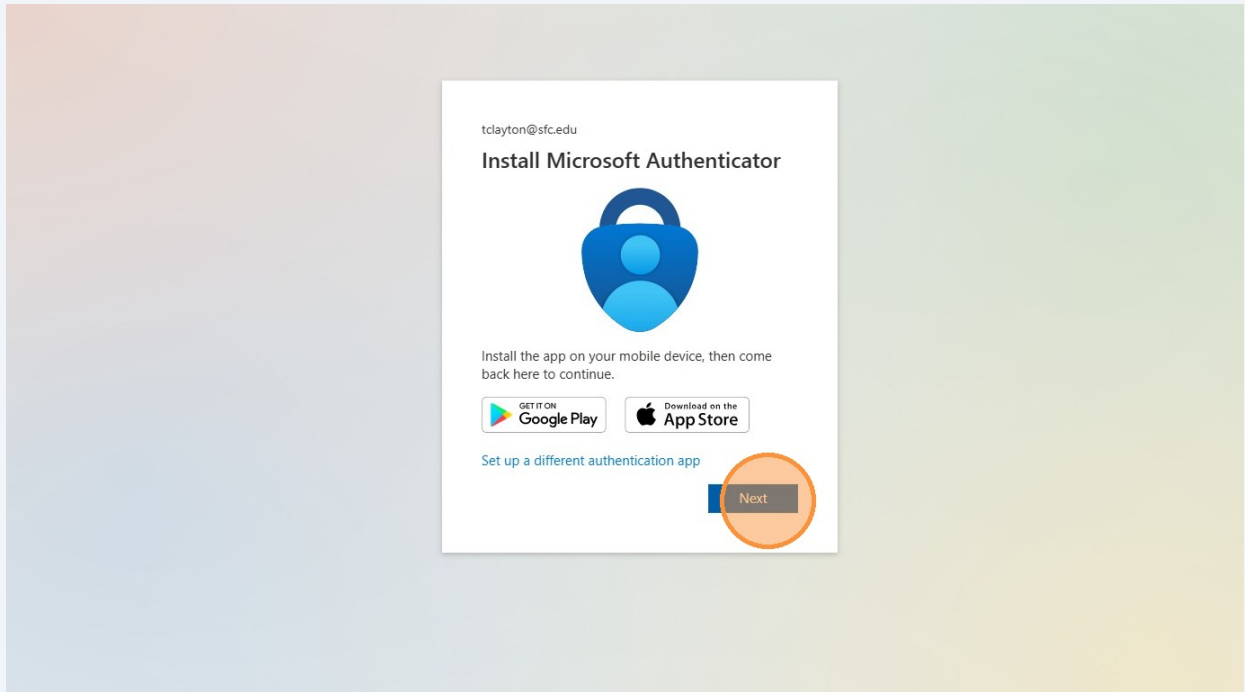

5

Click "Next"

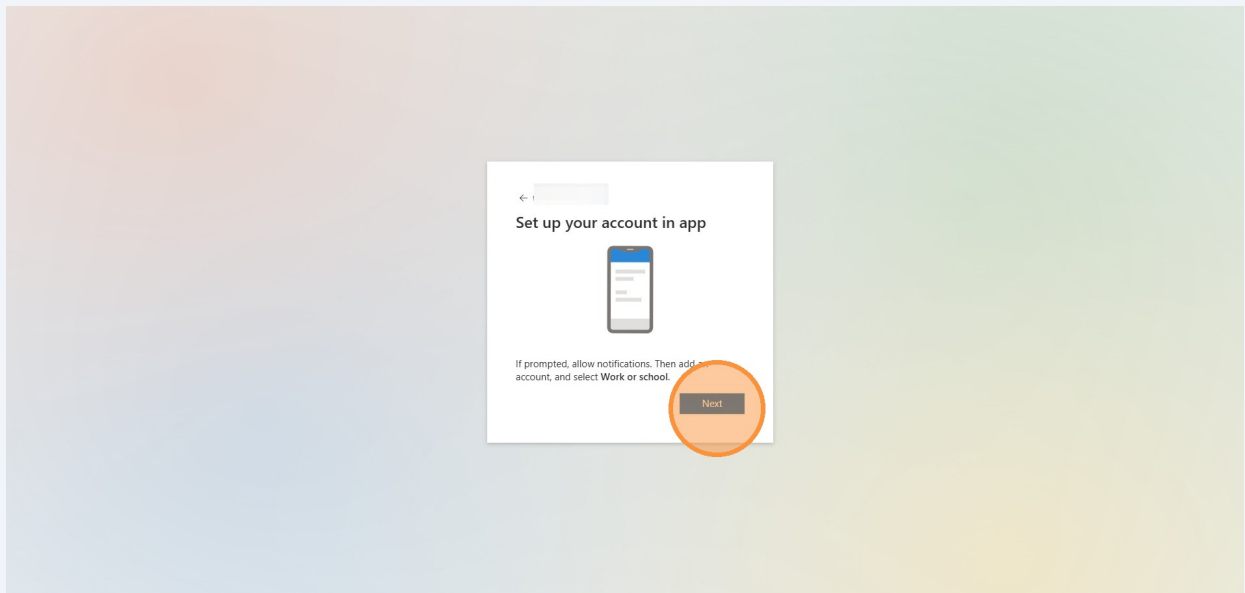

6

Use the Microsoft Authenticator to scan the provided QR code. Once scan is completed on device click "Next"

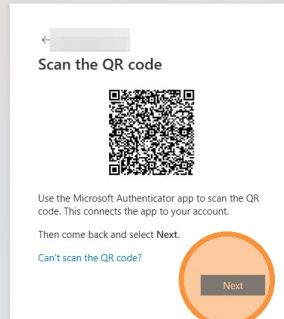

7

Test out the device connection with the random number that will be provided by Authenticator

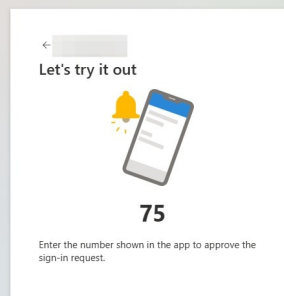

8 Once setup is complete, Click "Done"

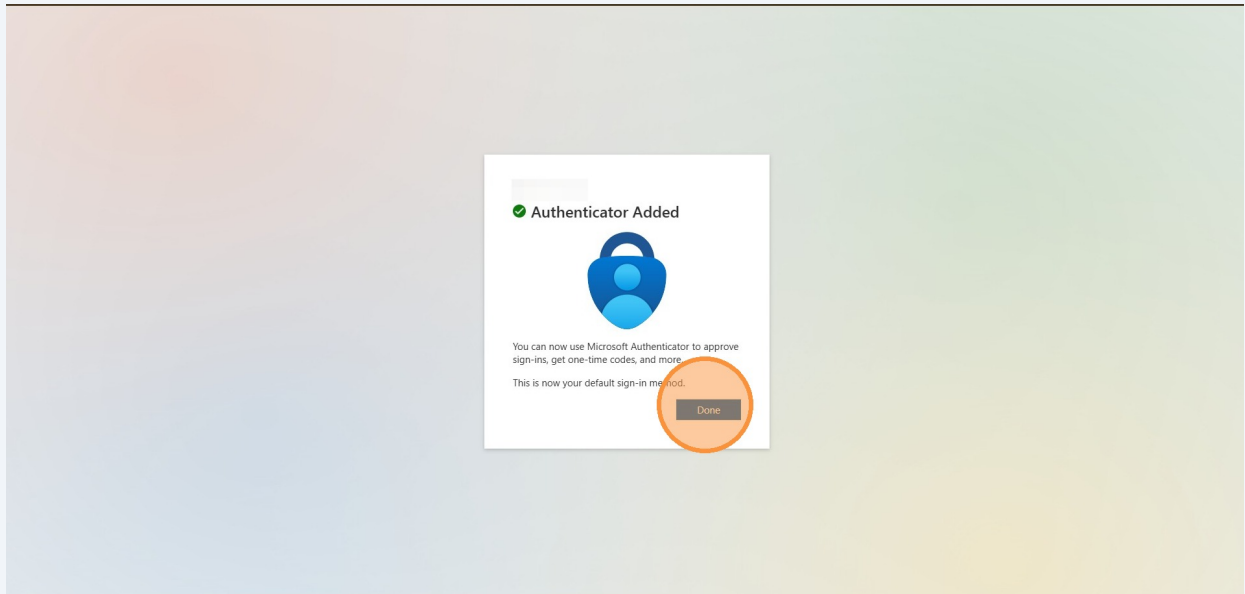

9 Complete a final verification with Authenticator to access your account.

